



From February 1st, 2017 SAMES Technologies SAS becomes SAMES KREMLIN SAS  
A partir du 1/02/17, SAMES Technologies SAS devient SAMES KREMLIN SAS



e-Jet VT - CS 237

e-Jet VT - CS 238



# User manual

**e - Jet - VT**  
**e - Jet - VT2**

**e-Jet**

DPCS Digital Preset Coating System

**SAS SAMES Technologies.** 13 Chemin de Malacher 38243 Meylan Cedex  
Tel. 33 (0)4 76 41 60 60 - Fax. 33 (0)4 76 41 60 90 - [www.sames.com](http://www.sames.com)

All communication or reproduction of this document, in any form whatsoever and all use or communication of its contents are forbidden without express written authorisation from SAMES Technologies.

The descriptions and characteristics mentioned in this document are subject to change without prior notice.

© SAMES Technologies 2008



**WARNING :** SAS Sames Technologies is registered with the Ministry of Labour as a training institution.

Throughout the year, our company offers training courses in the operation and maintenance of your equipment.

A catalogue is available on request. Choose from a wide range of courses to acquire the skills or knowledge that is required to match your production requirements and objectives.

Our training courses can be delivered at your site or in the training centre at our Meylan head office.

**Training department:**

**Tel. 33 (0)4 76 41 60 04**

**E-mail: [formation-client@sames.com](mailto:formation-client@sames.com)**

**SAS Sames Technologies** user manuals are written in French and translated into English, German, Spanish, Italian and Portuguese.

The French version is deemed the official text and Sames will not be liable for the translations into other languages.

e - Jet - VT

e - Jet - VT2

1. Safety Regulations	5
2. Description	6
2.1. General presentation	6
2.1.1. Vibrating table	6
2.1.2. Powder pump and powder pump tube	7
2.1.3. "Fast Pump"	7
2.1.4. Support arm for powder pump	7
2.1.5. Control panel	7
2.1.6. "Fast Clean"	7
3. Characteristics	8
3.1. General characteristics	8
3.2. Pneumatic characteristics	8
4. Operation	9
4.1. With vibrating table	9
5. Tools	9
6. Installation	10
6.1. Connecting the cart to ground system	10
6.2. Installing the CRN 457 on the cart	10
6.3. Installing the "e-Jet VT CS 237"	10
6.4. Installing the support arm of the "e-Jet VT CS238" cart	11
6.5. Connecting the hoses "e- Jet VT CS 237 or e-Jet VT CS 238"	12
6.6. Second powder pump kit "e- Jet VT2 CS 237 or e-Jet VT2 CS 238"	13
6.6.1. Connecting the hoses	13
6.6.2. Fitting the 2nd Fast Pump	15
6.6.3. Installing the 2 powder pump arm	15
6.7. Connecting the "Mach-Jet Gun" and the mains plug	16
7. Settings and start-up	17
8. Maintenance	18
8.1. Maintenance and periodic checks	18
8.1.1. Filter cartridge	18
9. Spare Parts	19
9.1. e-Jet - VT CS 238	19
9.1.1. VT Arm (one powder pump)	21
9.2. e - Jet - VT CS 237	22
9.3. e -Jet - VT2 CS 238	24
9.3.1. VT2 arm (two powder pumps)	27
9.4. e - Jet - VT2 CS 237	28

9.5. <i>E-Jet cart</i> . . . . .	31
9.5.1. <i>Vibrating table assembly</i> . . . . .	32
9.6. <i>e-Jet hose kit</i> . . . . .	33
9.7. <i>Air supply kit intended for the Canadian and American market</i>	34

## 1. Safety Regulations



**WARNING :** This document contains links to the following user manuals:

- [see RT Nr 6368](#) For the CS 237 and CS 238 powder pumps.
- [see RT Nr 6336](#) for the “Mach-Jet” spray gun and “CRN 457” control module.
- [see RT Nr 6410](#) for the Fast Clean.

**Note:** This device complies with the ATEX directive. This device may be dangerous if it is not used in compliance with the safety regulations specified in this manual.



**WARNING :** The “e-Jet” is intended for use with powder-paint spraying apparatus only.

- This device must only be used by personnel trained and accredited by SAMES Technologies. Operating staff must first read the user manual and the user manuals for any peripheral electrical equipment present in the spraying area. The workshop manager must ensure this is the case.
- The “e-Jet” cart must always be installed and used in areas where there is no risk of explosion.
- It is essential to connect the ground terminal on the cart to the ground system terminal of the powder-coating installation (or powder-coating booth) to guarantee the safety of operators and correct operation of the powder-coating equipment.
- When a vibrating table is used, the plastic bag containing the powder must be tightly wrapped around the plunger tube to avoid any escape of powder, which could create an explosive atmosphere.
- The box must be filled in a ventilated area designed for the purpose and under no circumstances anywhere near the cart.
- Under no circumstances may the cart be used to carry or transport loads other than the powder tank or a powder box with a maximum weight of 30 kg on the vibrating table.
- Ambient temperature must not exceed 40 °C (104°F).
- The spraying area must be kept clean and clear of any unnecessary items.
- The floor on which the operator works must be anti-static (bare concrete or metal duckboard). Never use an insulating floor covering.
- Powder spraying must be carried out in front of a ventilated booth designed for the purpose. Start-up of the CRN 457 control module must be interlocked with operation of the ventilation system.
- Skin-contact with or inhalation of products used with this equipment may be dangerous for personnel (cf.: Safety sheets for products used).
- The parts to be painted must have a resistance with respect to ground that is less than or equal to 1MΩ.
- Powder-spraying equipment must be maintained regularly according to the instructions laid out in this manual.
- Only genuine Sames Technologies spare parts can guarantee operating safety for the equipment.
- Genuine SAMES hoses must be used to connect the powder pump.

**Note:** there is a ground braid, secured under the lower body of the cart, to ensure flow of electrical charges in the case of accidental non-compliance of the connection with the cart’s grounding system. Under no circumstances must this safety device must be substituted for the “e-Jet” ground terminal connection.

## 2. Description

### 2.1. General presentation

The convenient, compact size of the “e-Jet” cart makes it easy to manoeuvre and move, with four freely-steerable wheels.

The cart includes the CRN 457 control module in front of the operator, at an angle that is optimised for comfort in use.

**Main components:**

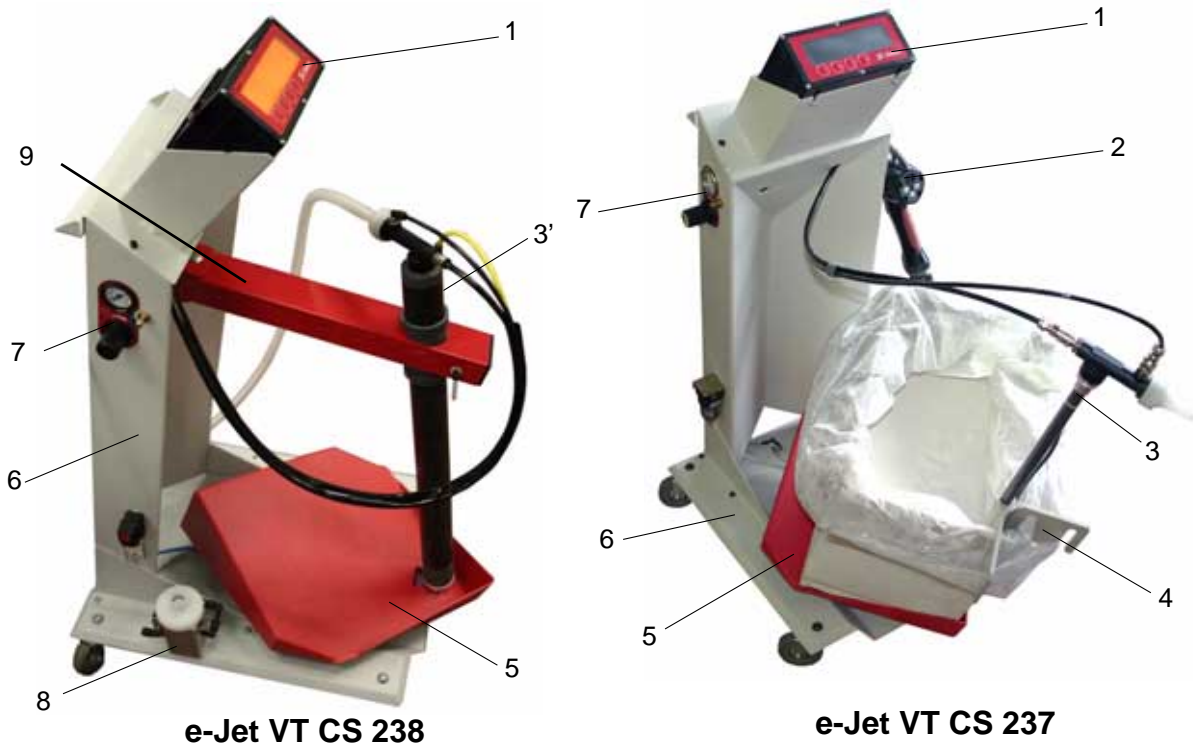

1	CRN 457 control module
2	“Mach-Jet gun”
3	Powder pump and suction tube CS237
3'	Powder pump and suction tube CS238
4	Fast pump
5	Vibrating table
6	Cart
7	Control panel
8	Fast Clean
9	Support arm for powder pump

#### 2.1.1. Vibrating table

This component enables standard powder boxes of up to 30 kg to be easily used.

It is fitted on the cart at a slight angle, in order to ensure the powder is fully taken up, even from the bottom of the box.

A high-performance pneumatic vibrator is used to vibrate the powder and minimise compaction. Vibration frequency can be adjusted according to the type of powder used and level of product remaining. Vibrator operation is activated with the spray gun trigger.

### 2.1.2. Powder pump and powder pump tube

A powder pump enables suction of the powder directly from the powder box. The suction tube tip ensures that the powder in the box is evenly fluidised to facilitate transport.

This “e-Jet” device also exists with a second powder pump (option).

Powder pump can be equipped with two types of tubes; the first, called CS 238, is installed on the cart “e-Jet VT CS 238”, the second, called CS 237, is installed on the cart “e-Jet VT CS 237” equipped with the Fast pump.

### 2.1.3. “Fast Pump”

The “Fast Pump” system is very easy to use. It enables the powder pump to be held in place directly on the box.

The powder pump CS 237 and its tube are clipped on to the “Fast Pump” and the tube therefore slides gently down as the powder level drops in the box. This ensures a regular flow rate for the powder pump. When the powder box is changed, the “Fast Pump” can easily be attached to the back of the cart, so the paint can be very quickly switched.

### 2.1.4. Support arm for powder pump

Integrated into the cart, it supports one or two powder pumps.

Gradually, the tube of the powder pump slides at the same time as the level of powder comes down in the box.

The arm can swivel on the side in order to release the access and locks itself in side position (except version 2 powder pumps).

### 2.1.5. Control panel

Item	Function
1	Vibrator air supply pressure adjustment and reading (for vibrating table)
2	Fluidisation air flow-rate adjustment (plunger tube)



### 2.1.6. “Fast Clean”

[see RT Nr 6410.](#)

- This equipment is designed to clean the inside of the powdered paint circuit using compressed air, from the CS 237 powder pump up to the spray gun.



### 3. Characteristics

#### 3.1. General characteristics

Because of the structure of the e-Jet:

- a box with a weight of approximately 30 kg (66 lb) of powder can be placed on a vibrating table at an angle.

e-Jet cart dimensions (h x w x d)	1020 x 440 x 640 mm
Approximate weight (without powder)	40 kg.
Operating temperature	from 0°C to 40°C (32°F to 104°F).

#### 3.2. Pneumatic characteristics

Characteristics of the compressed-air supply according to standard NF ISO 8573-1:

Maximum dew point at 6 bar (87 psi)	class 4, i.e. + 3 °C (37 ° F)
Maximum particle size of solid contaminants	Class 3, i.e. 5 µm.
Maximum oil concentration	Class 1, i.e. 0.01 mg/m <sup>3</sup> *
Maximum concentration of solid contaminants	5 mg / m <sup>3</sup> *

\* : Air flow-rate values are given for a temperature of 20° C (68 °F) at an atmospheric pressure of 1013 mbar.

The filter installed on the “e-Jet Cart” is used to ensure correct operation of the device in the event of accidental non-compliance with compressed-air filtering recommendations.

e-Jet Cart air supply pressure	7 bar ± 1 bar (*)
Maximum flow-rate	18 m <sup>3</sup> /h maximum



**WARNING :** (\*) Pressure in excess of 8 bar may cause malfunctions.

Maximum flow-rate:

Air flow-rate supplied by CRN 457 control module	Vibrating table 1 powder pump
“Fluidisation” air or vibrator air supply flow-rate.	12 m <sup>3</sup> /h maximum, of which 0.1 m <sup>3</sup> /h for fluidisation
Powder feed air flow-rate	6 m <sup>3</sup> /h maximum



## **4. Operation**

### **4.1. With vibrating table**

The powdered paint remains in its original box. The box is placed on the vibrating table.

The vibrator vibrates the table and enables the fluidisation head to reach the bottom of the powder box.

The fluidisation nozzle, with its compressed air supply, “fluidises” the powdered paint.

The powdered paint, fluidised in this way, is then carried by an air jet from the powder pump to the spray gun to which it is connected by a powder-carrying hose.

## **5. Tools**

No specific tools.

## 6. Installation

### 6.1. Connecting the cart to ground system



**WARNING :** The ground cable must be connected to the ground terminal of the powder-coating installation (see figure below).

There is a ground braid, secured under the lower body of the “e-Jet cart,” to ensure flow of electrical charges in the event of accidental non-compliance of the connection with the cart ground system.

Under no circumstances must this safety device must be substituted for the “e-Jet” ground terminal connection.



Wire to be connected to the ground

### 6.2. Installing the CRN 457 on the cart

Place control module CRN 457 in the specially designed housing and attach with the securing screw.



Securing Screw

### 6.3. Installing the “e-Jet VT CS 237”

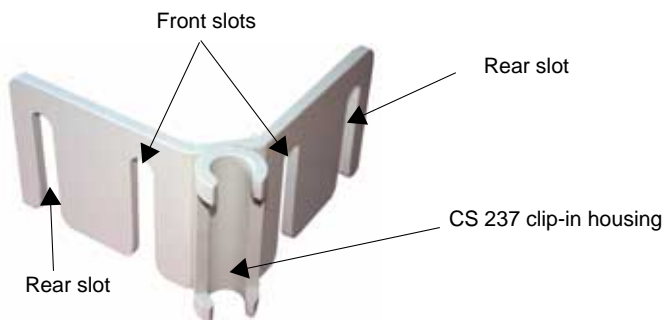

- **Step 1:** Clip the CS 237 onto the “Fast Pump”, slide the two “Fast Pump” front slots onto the powder box.
- **Step 2:** Insert the edges of the powder bag into the two rear slots of the “Fast Pump”.
- **Step 3:** Push the CS 237 into the powder (1 or 2 cm), whilst holding down the spray gun trigger.
- **Step 4:** Press the spray gun trigger, then set the fluidisation air flow-rate to the highest value at which no fumes are released from the powder box.
- **Step 5:** The vibrator air pressure should be set such that the CS 237 plunger gradually slides downwards.



**WARNING :** The plastic bag containing the powder must be tightly wrapped around the plunger tube to avoid any escape of powder.

#### 6.4. Installing the support arm of the "e-Jet VT CS238" cart

Screw  
M 6 x 16

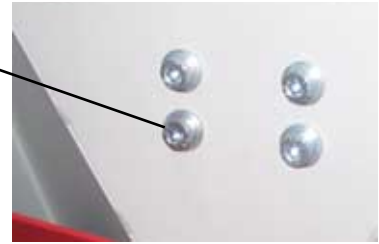

- Tighten the four M 6 x 16 screws in order to put in place the arm on the cart.  
Proceed in the same way for the VT2 arm.



**Remarks: Arm can be left in high position thanks to its securing system.**

Securing system



**The arm (one powder pump only) swivels on the side in order to release the access and can be blocked in side position.**



6.5. Connecting the hoses "e- Jet VT CS 237 or e-Jet VT CS 238"

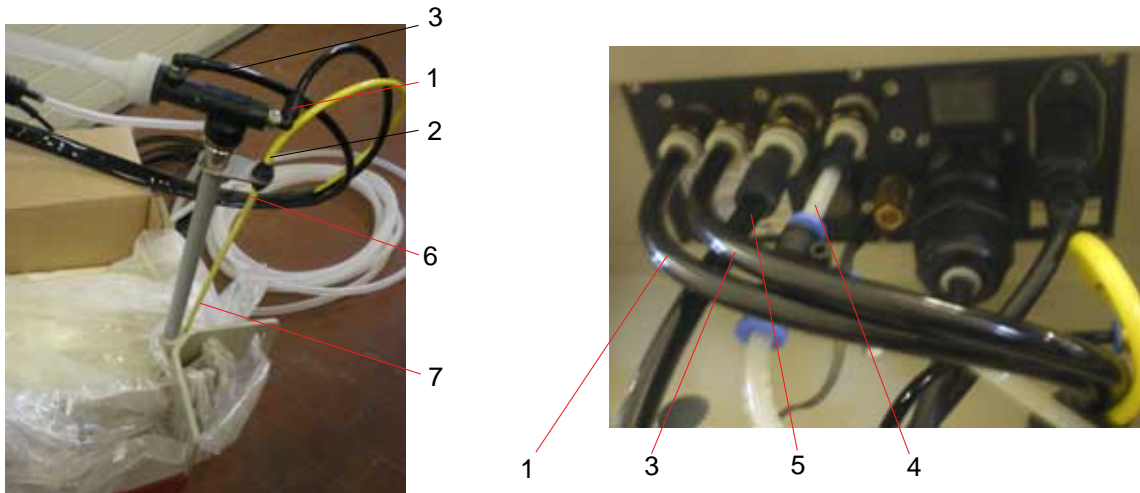

Item	Hose description	Hose characteristics
1	Injection air	Black polyurethane hose - Dia: 8
2	Fluidisation air	Clear polyamide hose - Dia: 6
3	Dilution air	Black polyurethane hose - Dia: 6
4	Vibrator air supply	Clear polyurethane hose - Dia: 4
5	General air supply	Black polyurethane hose - Dia: 8

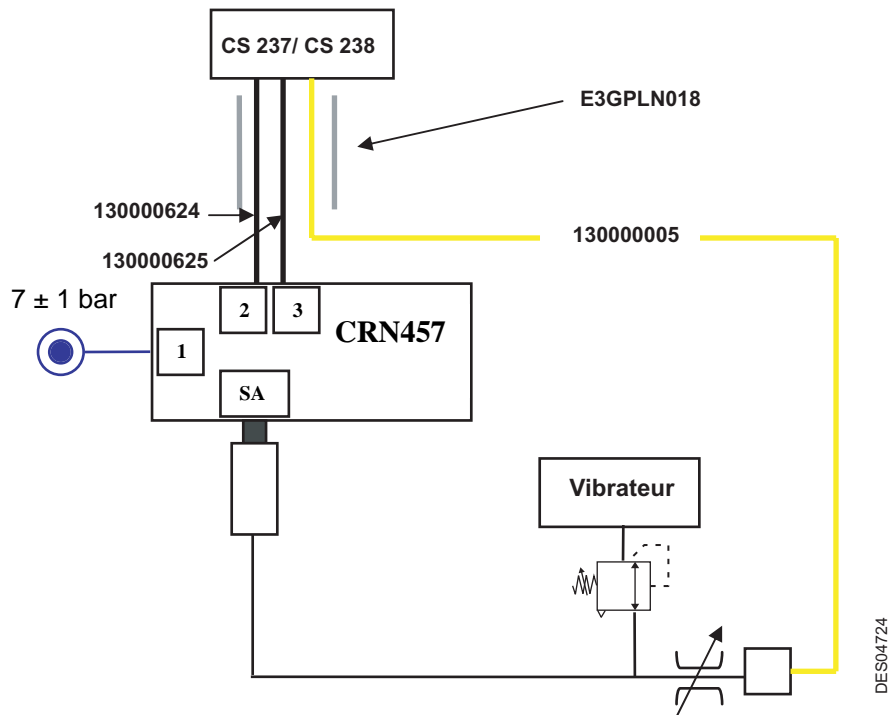

**WARNING :** When disassembling the plunger, make sure that the restrictor (item 6) is present in the supply hose (item 7).

## 6.6. Second powder pump kit "e- Jet VT2 CS 237 or e-Jet VT2 CS 238"

### 6.6.1. Connecting the hoses

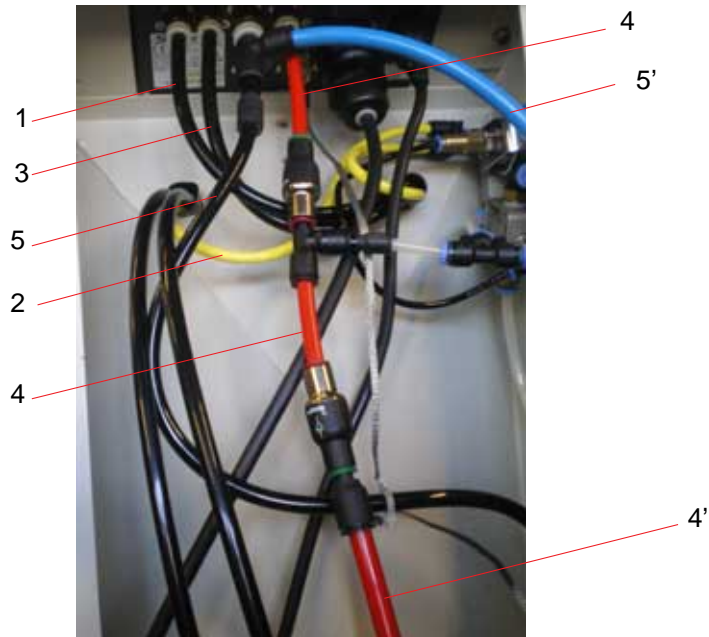

Item	Hose description	Hose characteristics
1	Injection air	Black polyurethane hose - Dia: 8
2	Fluidisation air	Yellow polyurethane hose - Dia: 6 mm
3	Dilution air	Black polyurethane hose - Dia: 6
4	Vibrator air supply	Red polyurethane hose - Dia: 8 mm
4'	Vibrator air supply	Red polyurethane hose - Dia: 10 mm
5	General air supply	Black polyurethane hose - Dia: 8 mm
5'	General air supply	Blue polyurethane hose - Dia: 10 mm

**Note: An additional "CRN 457" control module for controlling the second Mach-Jet Gun is connected to the second powder pump. This module is wall-mounted on a bracket at a maximum distance of 10 metres from the cart.**

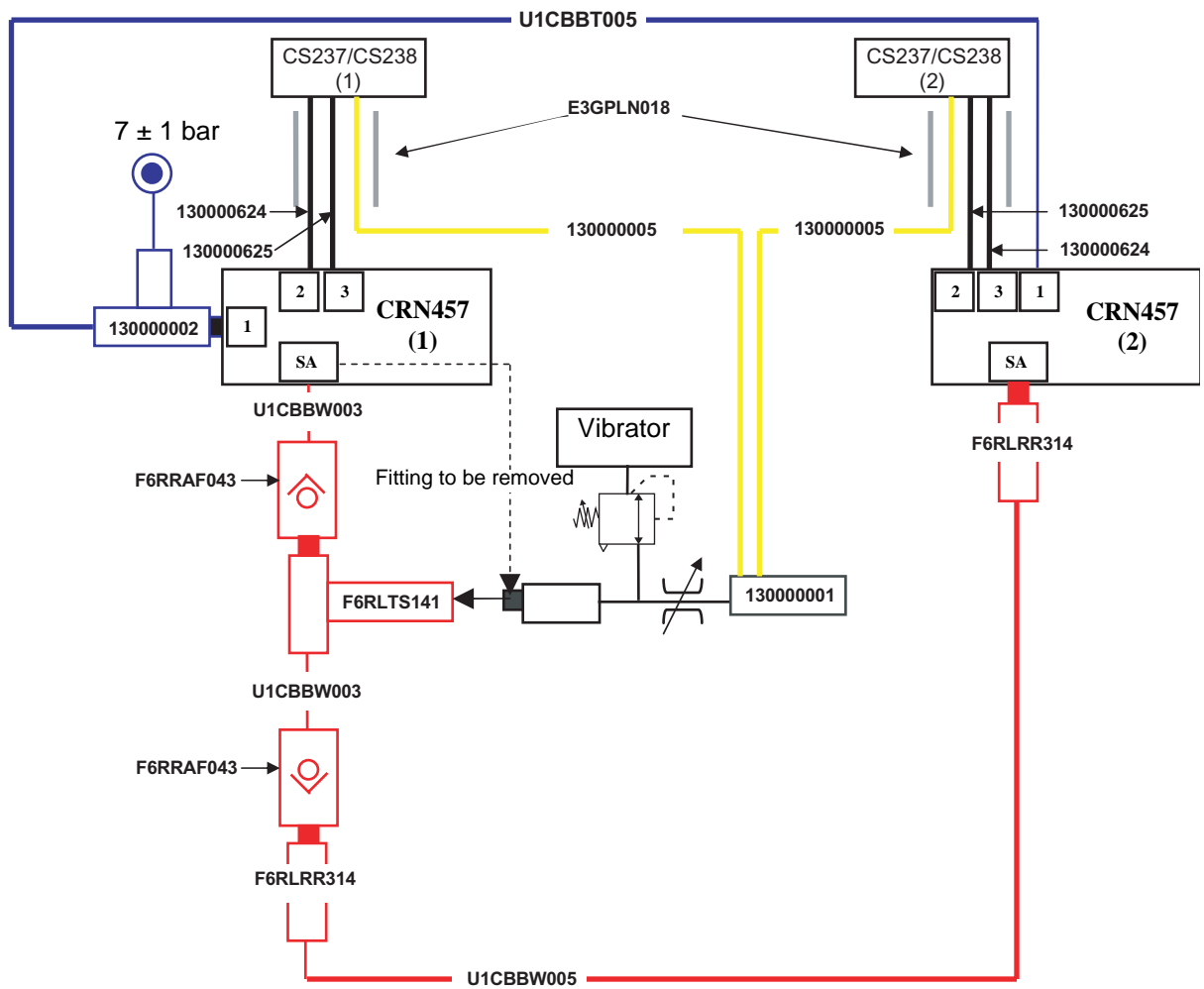

### 6.6.2. Fitting the 2nd Fast Pump

If this option is selected, a second Fast Pump will need to be fitted for the second powder pump (see illustration below).



### 6.6.3. Installing the 2 powder pump arm

For this option, it is necessary to use the specific arm for the two powder pumps ([see § 9.3.1 page 27](#)).

### 6.7. Connecting the “Mach-Jet Gun” and the mains plug

Connect the spray gun to plug “A” on the back of the control module ([see RT Nr 6336](#)).



**WARNING :** To avoid damaging the plug, make sure that the spray gun positioning device is opposite the positioning device on the CRN 457 base plate.

The plug is locked by pushing it into the socket; comply with positioning devices: The flat side of the spray gun cable plug must be at the top. **“Click” it into place. The click indicates that the plug is correctly locked in position.**

The plug is unlocked by pulling it out of the socket.



Flat side

Positioning devices



**WARNING :** Hold the front of the control module when connecting hoses or cables.

The mains power cable is connected to the back of the CRN 457 (see figure below).



Mains power cable

Spray gun plug “A”



## 7. Settings and start-up

Once the equipment has been installed in accordance with the safety regulations ([see § 1 page 5](#)) and instructions ([see § 6 page 10](#)), follow the steps described below.

- **Step 1:** Switch on the CRN 457 control module ([see RT Nr 6336](#)) (switch located on back of module).
- **Step 2:** Configure the CRN 457 control module ([see RT Nr 6336](#)), for operation with vibrating table.
- **Step 3:** Place an open powder box on the vibrating table.  
For the "e-Jet VT CS 237" cart: Place the "Fast Pump" on one edge of the box, attach the plastic bag containing the powder to the "Fast Pump" and wrap the plastic bag carefully around the powder pump tube.  
For the "e-Jet VT CS 238" cart: Place the tube in the box and wrap the plastic bag carefully around the powder pump tube.



**After pressing the spray gun trigger:**

- **Step 4:** Adjust the vibrator air regulator (pressure between 1 and 2 bar maximum).
- **Step 5:** Set the adjustable fluidisation air flow-rate restrictor



- **Step 6:** ([see RT Nr 6336](#)) to adjust the required powder flow-rate on the spray gun or control module.

## 8. Maintenance

### 8.1. Maintenance and periodic checks



**WARNING** : Cleaning operations must only be carried out using compressed air of maximum pressure 2.5 bar and a cloth. Water and solvents must not be used to clean the equipment. The equipment must be cleaned at the end of each shift.

- The air filter cartridge must be replaced regularly, approximately every 6 months ([see § 8.1.1 page 18](#)).
- If there is water or oil in the filter, drain the tank and check the device's air dryer or oil remover. To drain the tank, simply unscrew the black plastic part located underneath the filter bowl.

#### 8.1.1. Filter cartridge

##### Disassembly

- Disconnect the general power supply.
- Unscrew the union filter with a 14 mm open-ended spanner to remove the full filter assembly.
- Place the filter in a vice, holding it in position by its metal part.
- Carefully unscrew the filter bowl (transparent part) using tongue and groove (slip joint) pliers. Clean it with a neutral detergent.
- Unscrew the central screw retaining the filter cartridge using a Phillip's screwdriver.

##### Reassembly

- Fit a new filter cartridge and moderately tighten the retaining screw.
- Place the O-ring at the bottom of the base.
- Install the filter bowl and hand-tighten.
- Seal the union and re-fit the filter.
- Re-connect the general power supply.

## 9. Spare Parts

### 9.1. e-Jet - VT CS 238

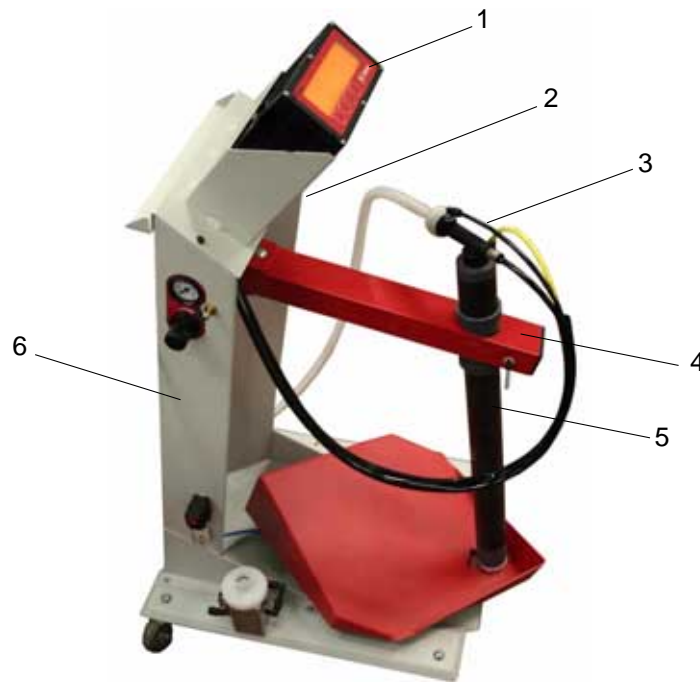

#### Europe Version

Item	Part number	Description	Qty	Unit of sale	Spare Part Level (*)
	910008652	e-Jet equipped with a Mach-Jet Gun (6 m)	1	1	3
	910008654	e-Jet equipped with a Mach-Jet Gun (12 m)	1	1	3
1	1523297	CRN 457 control module (see RT Nr 6336)	1	1	3
2	1524463	Mach-Jet Gun (6 m) (see RT Nr 6336)	1	1	3
	1524463-12	Mach-Jet Gun (12 m) (see RT Nr 6336)	1	1	3
3	910006386	e-Jet hose kit (see § 9.6 page 33)	1	1	2
4	910007790	VT arm (1 powder pump) (see § 9.1.1 page 21)	1	1	3
5	910008574	CS 238 powder pump (see RT Nr 6368)	1	1	1
6	-	e-Jet cart (see § 9.5 page 31)	1	not sold separately	-
<b>Not shown</b>					
	842635	5-m ground cable, lug dia.: 6	1	1	3
	E4PCAL206	Mains power cable 10A 250V	1	1	3

USA version

Item	Part number	Description	Qty	Unit of sale	Spare Part Level (*)
	910008653	e-Jet equipped with a Mach-Jet Gun (6 m)	1	1	3
	910008655	e-Jet equipped with a Mach-Jet Gun (12 m)	1	1	3
1	1523297	CRN 457 control module (see RT Nr 6336)	1	1	3
2	1524463	Mach-Jet Gun (6 m) (see RT Nr 6336)	1	1	3
	1524463-12	Mach-Jet Gun (12 m) (see RT Nr 6336)	1	1	3
3	910006386	e-Jet hose kit (see § 9.6 page 33)	1	1	2
4	910008574	CS 238 powder pump (see RT Nr 6368)	1	1	1
5	910007790	VT arm (1 powder pump) (see § 9.1.1 page 21)	1	1	3
6	-	e-Jet cart (see § 9.5 page 31)	1	Not sold separately	-
<b>Not shown</b>					
	842635	5-m ground cable, lug dia.: 6	1	1	3
	E4PCAL459	USA Mains power cable	1	1	3
	E4PCAL459	USA Mains power cable	1	1	3
	910007107	Air supply kit (see § 9.7 page 34)	1	1	3

(\*)

Level 1: Standard preventive maintenance

Level 2: Corrective maintenance

Level 3: Exceptional maintenance

9.1.1. VT Arm (one powder pump)

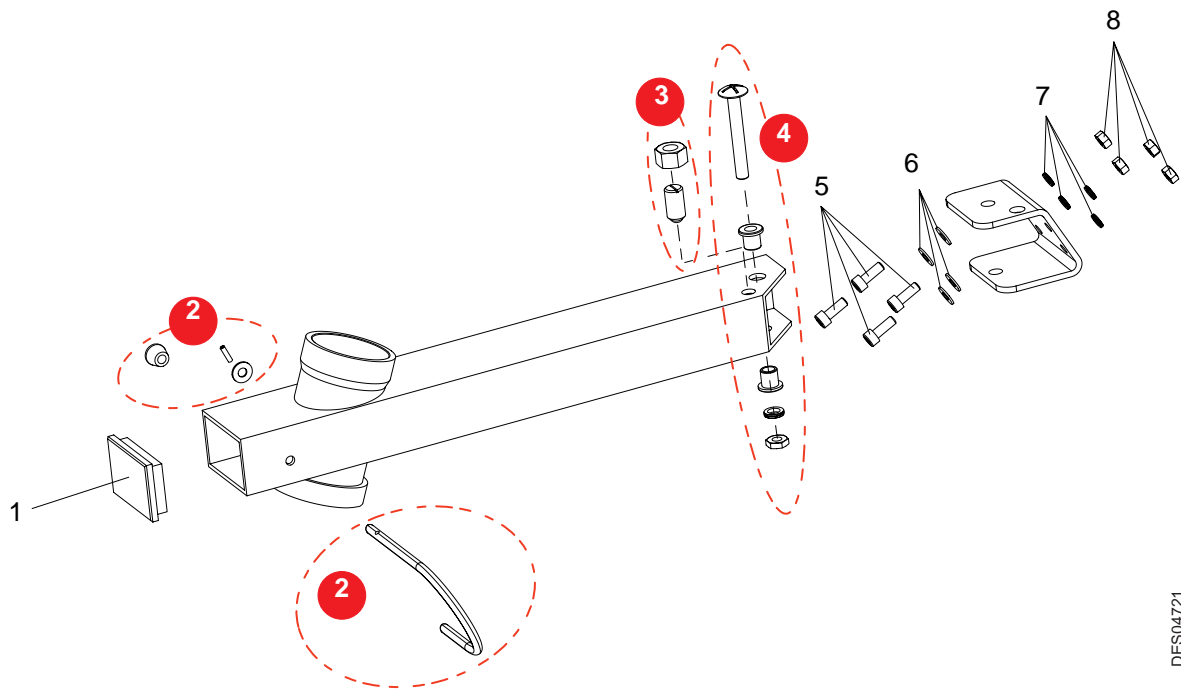

DES04721

Item	Part number	Description	Qty	Unit of sale	Spare Part Level (*)
	<b>910007790</b>	<b>VT arm (1 powder pump)</b>	<b>1</b>	<b>1</b>	<b>3</b>
1	130000794	Plug	1	1	3
2	<b>910008674</b>	<b>Fixing clamp assembly</b>	<b>1</b>	<b>1</b>	<b>2</b>
3	<b>910008675</b>	<b>Blocking system unit of the arm</b>	<b>1</b>	<b>1</b>	<b>2</b>
4	<b>910008673</b>	<b>Arm axle assembly</b>	<b>1</b>	<b>1</b>	<b>2</b>
5	X3AVSY223	Screw Chc M6 / 16 zinc coated steel	4	1	3
6	X2BDMU006	Washer M6 U zinc coated steel	4	1	3
7	X3CDSP783	Self locking washer	4	1	3
8	X2BEHU006	Nut H M6 U zinc coated steel	4	1	3

(\*)

**Level 1: Standard preventive maintenance**

**Level 2: Corrective maintenance**

**Level 3: Exceptional maintenance**

## 9.2. e - Jet - VT CS 237



### Europe version

Item	Part number	Description	Qty	Unit of sale	Spare Part Level (*)
	910006388	e-Jet equipped with a Mach-Jet Gun (6 m)	1	1	3
	910006389	e-Jet equipped with a Mach-Jet Gun (12 m)	1	1	3
1	1523297	CRN 457 control module (see RT Nr 6336)	1	1	3
2	1524463	Mach-Jet Gun (6 m) (see RT Nr 6336)	1	1	3
	1524463-12	Mach-Jet Gun (12 m) (see RT Nr 6336)	1	1	3
3	910006386	e-Jet hose kit (see § 9.6 page 33 )	1	1	2
4	1526401	CS 237 plunger (see RT Nr 6368)	1	1	1
5	900003577	Fast Pump	1	1	3
6	-	e-Jet cart (see § 9.5 page 31)	1	not sold separately	-
<b>Not shown</b>					
	842635	5-m ground cable, lug dia.: 6	1	1	3
	E4PCAL206	Mains power cable 10A 250V	1	1	3

USA version

Item	Part number	Description	Qty	Unit of sale	Spare Part Level (*)
	910006747	e-Jet equipped with a Mach-Jet Gun (6 m)	1	1	3
	910006748	e-Jet equipped with a Mach-Jet Gun (12 m)	1	1	3
1	1523297	CRN 457 control module (see RT Nr 6336)	1	1	3
2	1524463	Mach-Jet Gun (6 m) (see RT Nr 6336)	1	1	3
	1524463-12	Mach-Jet Gun (12 m) (see RT Nr 6336)	1	1	3
3	910006386	e-Jet hose kit (see § 9.6 page 33 )	1	1	2
4	1526401	CS 237 plunger (see RT Nr 6368)	1	1	1
5	900003577	Fast Pump	1	1	3
6	-	e-Jet cart (see § 9.5 page 31)	1	not sold separately	-
<b>Not shown</b>					
	842635	5-m ground cable, lug dia.: 6	1	1	3
	E4PCAL459	USA Mains power cable	1	1	3
	910007107	Air supply kit (see § 9.7 page 34)	1	1	3

(\*)

Level 1: Standard preventive maintenance

Level 2: Corrective maintenance

Level 3: Exceptional maintenance

9.3. e -Jet - VT2 CS 238

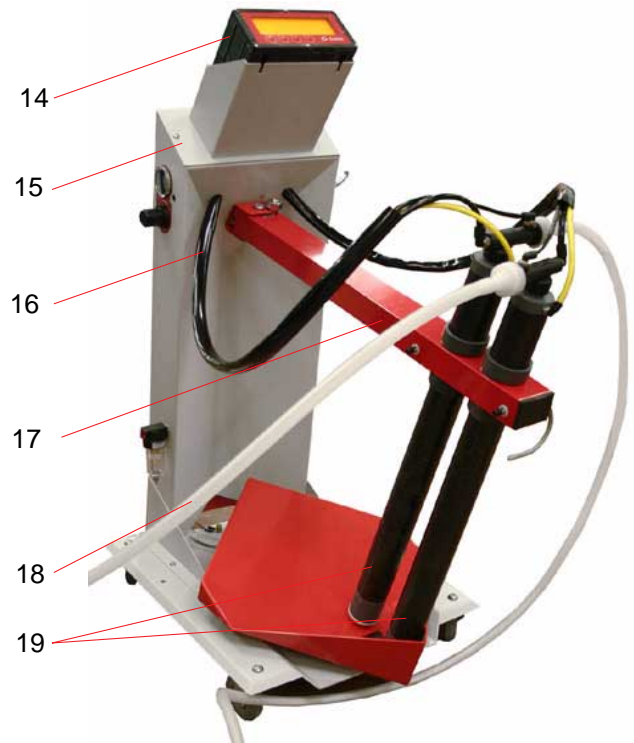
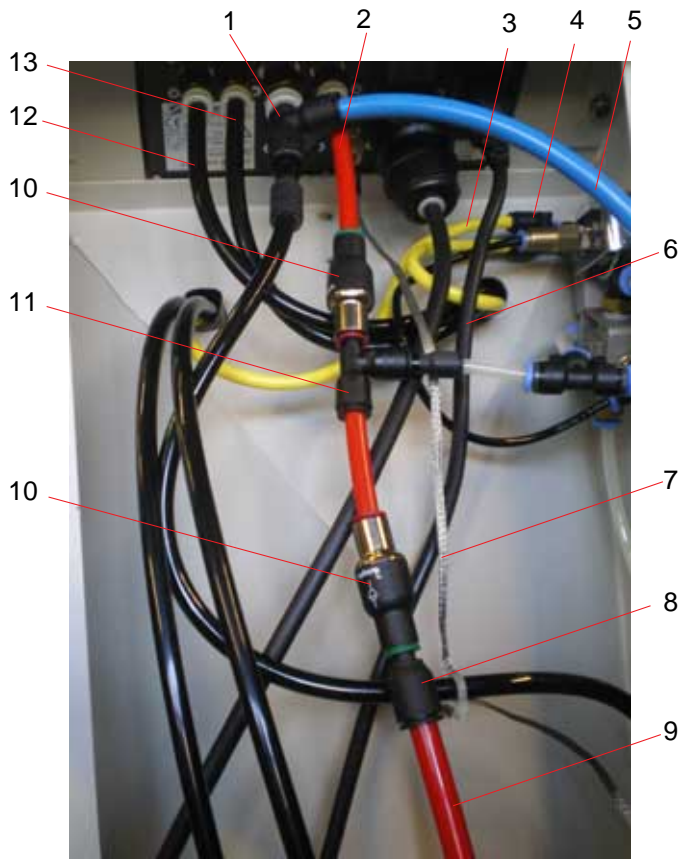



Europe version

Item	Part number	Description	Qty	Unit of sale	Spare Part Level (*)
	<b>910008656</b>	<b>e-Jet equipped with one 6 m Mach-Jet Gun and one 12 m Mach-Jet Gun</b>	<b>1</b>	<b>1</b>	<b>3</b>
1	130000002	Tee Union	1	1	3
2	U1CBBW003	Red polyamide hose 6/8	0,2	m	2
3	130000005	Yellow polyurethane hose 4/6	2,8	m	2
4	130000001	Quick-release Y-shaped union	1	1	3
5	U1CBBT005	Blue polyamide hose 8/10	10	m	2
6	E4PCAL206	Mains power cable 10A 250V	2	1	3
7	842635	5-m ground cable, lug dia.: 6	2	1	3
8	F6RLRR314	Quick-release diameter adapter	2	1	3
9	U1CBBW005	Red polyamide hose 8/10	10	m	2
10	F6RRAF043	Double check union	2	1	3
11	F6RLTS416	Tee Union	1	1	3
12	130000624	Black semi-conducting polyurethane hose - 5.5/8	11,4	m	2
13	130000625	Black semi-conducting polyurethane hose - 4/6	11,4	m	2
<b>14</b>	<b>1523297</b>	<b>CRN 457 control module</b> ( <a href="#">see RT Nr 6336</a> )	<b>2</b>	<b>1</b>	<b>3</b>
<b>15</b>	-	<b>e-Jet cart</b> ( <a href="#">see § 9.5 page 31</a> )	<b>1</b>	<b>not sold separately</b>	<b>-</b>
16	E3GPLN018	PVC sheath, black	1,6	m	2
<b>17</b>	<b>910008573</b>	<b>VT2 arm</b> ( <a href="#">see § 9.3.1 page 27</a> )	<b>1</b>	<b>1</b>	<b>3</b>
18	U1FGBA092	Hose EAV 11X15	12	m	1
<b>19</b>	<b>910008574</b>	<b>CS 238 powder pump</b> ( <a href="#">see RT Nr 6368</a> )	<b>2</b>	<b>1</b>	<b>1</b>
<b>Not shown</b>					
	<b>1524463</b>	<b>Mach-Jet Gun (6 m)</b> ( <a href="#">see RT Nr 6336</a> )	<b>1</b>	<b>1</b>	<b>3</b>
	<b>1524463-12</b>	<b>Mach-Jet Gun (12 m)</b> ( <a href="#">see RT Nr 6336</a> )	<b>1</b>	<b>1</b>	<b>3</b>
<b>For 2nd CRN 457</b>					
	F6RLDS408	Quick-release bracket, dia.: 8	2	1	3
	F6RLDS207	Quick-release bracket, dia.: 6	1	1	3
	F6RLDS145	Quick-release bracket, dia.: 10	1	1	3
	822542	Support bracket assembly for 2nd CRN 457	1	1	3

(\*)

**Level 1: Standard preventive maintenance**

**Level 2: Corrective maintenance**

**Level 3: Exceptional maintenance**

USA version

Item	Part number	Description	Qty	Unit of sale	Spare Part Level (*)
	<b>910008657</b>	<b>e-Jet equipped with one 6 m Mach-Jet Gun and one 12 m Mach-Jet Gun</b>	<b>1</b>	<b>1</b>	<b>3</b>
1	130000002	Tee Union	1	1	3
2	U1CBBW003	Red polyamide hose 6/8	0,2	m	2
3	130000005	Yellow polyurethane hose 4/6	2,8	m	2
4	130000001	Quick-release Y-shaped union	1	1	3
5	U1CBBT005	Blue polyamide hose 8/10	10	m	2
6	E4PCAL459	US Mains power cable	2	1	3
7	842635	5-m ground cable, lug dia.: 6	2	1	3
8	F6RLRR314	Quick-release diameter adapter	2	1	3
9	U1CBBW005	Red polyamide hose 8/10	10	m	2
10	F6RRAF043	Double check union	2	1	3
11	F6RLTS416	Tee Union	1	1	3
12	130000624	Black semi-conducting polyurethane hose - 5.5/8	11,4	m	2
13	130000625	Black semi-conducting polyurethane hose - 4/6	11,4	m	2
<b>14</b>	<b>1523297</b>	<b>CRN 457 control module</b> ( <a href="#">see RT Nr 6336</a> )	<b>2</b>	<b>1</b>	<b>3</b>
<b>15</b>	-	<b>e-Jet cart</b> ( <a href="#">see § 9.5 page 31</a> )	<b>1</b>	<b>not sold separately</b>	<b>-</b>
16	E3GPLN018	PVC sheath, black	0,8	m	2
<b>17</b>	<b>910008573</b>	<b>VT2 arm</b> ( <a href="#">see § 9.3.1 page 27</a> )	<b>1</b>	<b>1</b>	<b>3</b>
18	U1FGBA092	Hose EAV 11X15	12	m	1
<b>19</b>	<b>910008574</b>	<b>CS 238 powder pump</b> ( <a href="#">see RT Nr 6368</a> )	<b>2</b>	<b>1</b>	<b>1</b>
<b>Not shown</b>					
	<b>1524463</b>	<b>Mach-Jet Gun (6 m)</b> ( <a href="#">see RT Nr 6336</a> )	<b>1</b>	<b>1</b>	<b>3</b>
	<b>1524463-12</b>	<b>Mach-Jet Gun (12 m)</b> ( <a href="#">see RT Nr 6336</a> )	<b>1</b>	<b>1</b>	<b>3</b>
	<b>910007107</b>	<b>Air supply kit</b> ( <a href="#">see § 9.7 page 34</a> )	<b>1</b>	<b>1</b>	<b>3</b>
<b>For 2nd CRN 457</b>					
	F6RLDS408	Quick-release bracket, dia.: 8	2	1	3
	F6RLDS207	Quick-release bracket, dia.: 6	1	1	3
	F6RLDS145	Quick-release bracket, dia.: 10	1	1	3
	822542	Support bracket assembly for 2nd CRN 457	1	1	3

(\*)

**Level 1: Standard preventive maintenance**

**Level 2: Corrective maintenance**

**Level 3: Exceptional maintenance**

9.3.1. VT2 arm (two powder pumps)

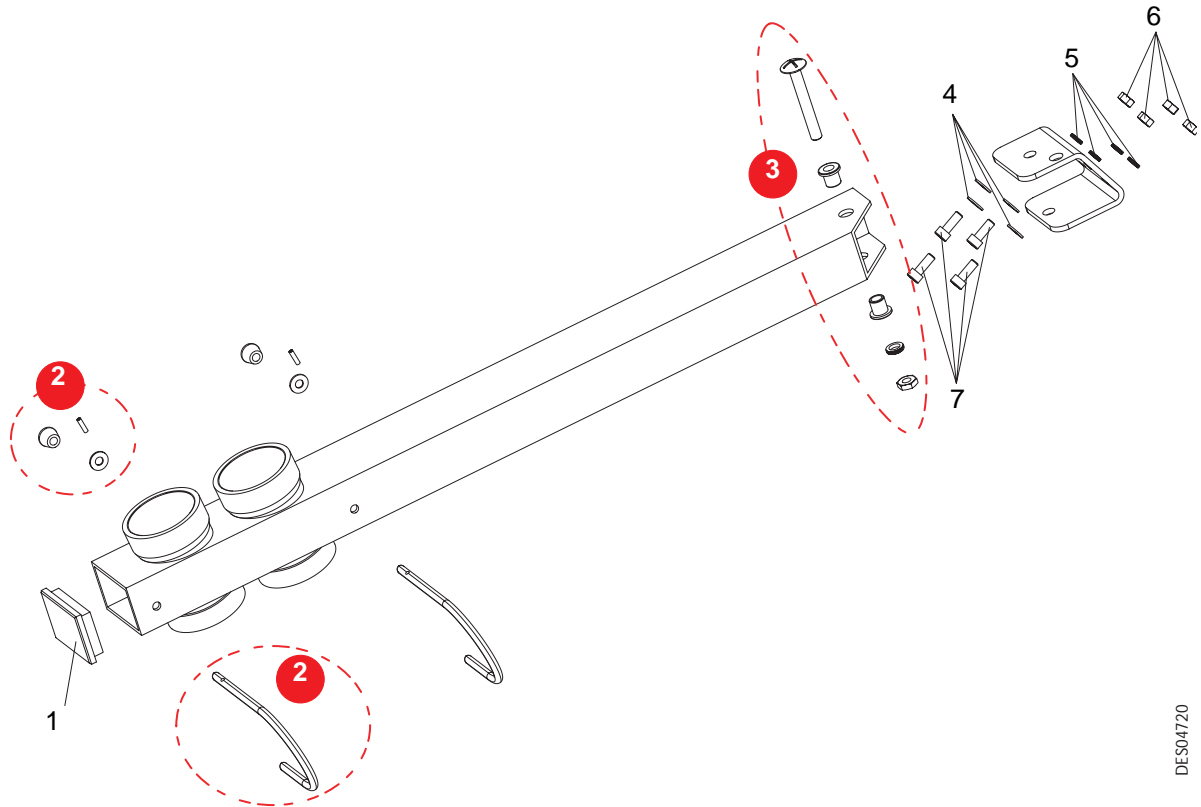

DES04720

Item	Part number	Description	Qty	Unit of sale	Spare Part Level (*)
	<b>910008573</b>	<b>VT2 arm (2 powder pumps)</b>	<b>1</b>	<b>1</b>	<b>3</b>
1	130000794	Plug	1	1	3
2	<b>910008674</b>	<b>Fixing clamp assembly</b>	<b>2</b>	<b>1</b>	<b>2</b>
3	<b>910008673</b>	<b>Arm axle assembly</b>	<b>1</b>	<b>1</b>	<b>2</b>
4	X2BDMU006	Washer M6 U zinc coated steel	4	1	3
5	X3CDSP783	Self locking washer	4	1	3
6	X2BEHU006	Nut H M6 U zinc coated steel	4	1	3
7	X3AVSY223	Screw Chc M6 / 16 zinc coated steel	4	1	3

(\*)

**Level 1: Standard preventive maintenance**

**Level 2: Corrective maintenance**

**Level 3: Exceptional maintenance**

9.4. e - Jet - VT2 CS 237

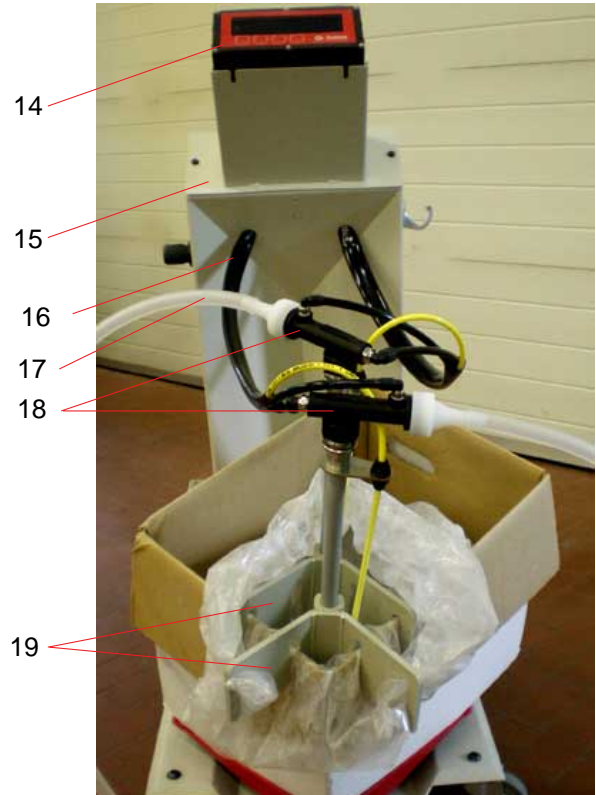
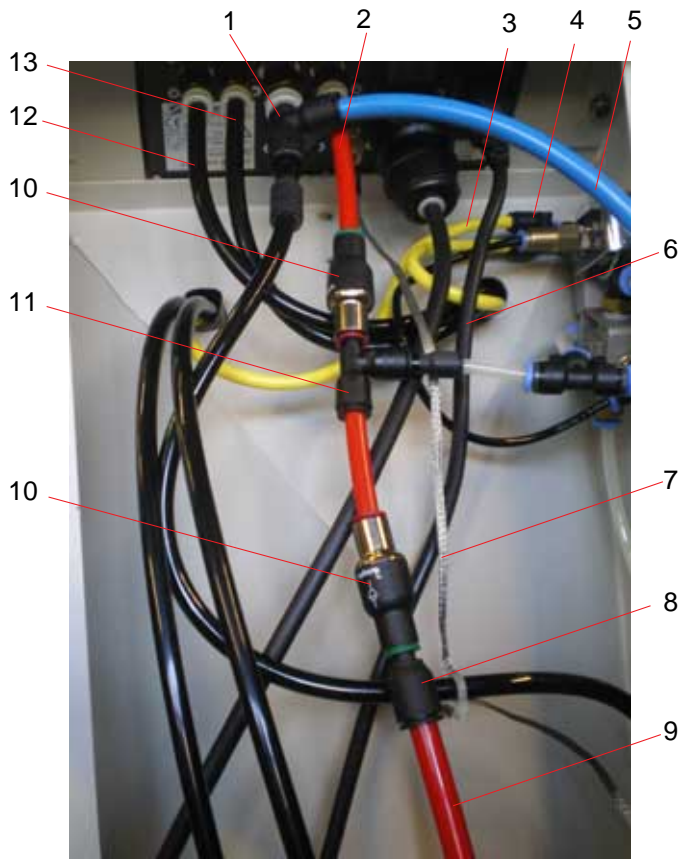

Europa version

Item	Part number	Description	Qty	Unit of sale	Spare Part Level (*)
	<b>910006396</b>	<b>e-Jet equipped with one 6 m Mach-Jet Gun and one 12 m Mach-Jet Gun</b>	<b>1</b>	<b>1</b>	<b>3</b>
1	130000002	Tee Union	1	1	3
2	U1CBBW003	Red polyamide hose 6/8	0.2	m	2
3	130000005	Yellow polyurethane hose 4/6	2.8	m	2
4	130000001	Quick-release Y-shaped union	1	1	3
5	U1CBBT005	Blue polyamide hose 8/10	10	m	2
6	E4PCAL206	Mains power cable 10A 250V	2	1	3
7	842635	5-m ground cable, lug dia.: 6	2	1	3
8	F6RLRR314	Quick-release diameter adapter	2	1	3
9	U1CBBW005	Red polyamide hose 8/10	10	m	2
10	F6RRAF043	Double check union	2	1	3
11	F6RLTS416	Tee Union	1	1	3
12	130000624	Black semi-conducting polyurethane hose - 5.5/8	11.4	m	2
13	130000625	Black semi-conducting polyurethane hose - 4/6	11.4	m	2
<b>14</b>	<b>1523297</b>	<b>CRN 457 control module</b> ( <a href="#">see RT Nr 6336</a> )	<b>2</b>	<b>1</b>	<b>3</b>
<b>15</b>	-	<b>e-Jet cart</b> ( <a href="#">see § 9.5 page 31</a> )	<b>1</b>	<b>not sold separately</b>	<b>-</b>
16	E3GPLN018	PVC sheath, black	0,8	m	2
17	U1FGBA092	Hose EAV 11X15	12	m	1
<b>18</b>	<b>1526401</b>	<b>CS 237 plunger</b> ( <a href="#">see RT Nr 6368</a> )	<b>2</b>	<b>1</b>	<b>1</b>
19	900003577	Fast Pump	2	1	3
<b>Not shown</b>					
	<b>1524463</b>	<b>Mach-Jet Gun (6 m)</b> ( <a href="#">see RT Nr 6336</a> )	<b>1</b>	<b>1</b>	<b>3</b>
	<b>1524463-12</b>	<b>Mach-Jet Gun (12 m)</b> ( <a href="#">see RT Nr 6336</a> )	<b>1</b>	<b>1</b>	<b>3</b>
<b>For 2nd CRN 457</b>					
	F6RLDS408	Quick-release bracket, dia.: 8	2	1	3
	F6RLDS207	Quick-release bracket, dia.: 6	1	1	3
	F6RLDS145	Quick-release bracket, dia.: 10	1	1	3
	822542	Support bracket assembly for 2nd CRN 457	1	1	3

**Level 1: Standard preventive maintenance**

**Level 2: Corrective maintenance**

**Level 3: Exceptional maintenance**

USA version

Item	Part number	Description	Qty	Unit of sale	Spare Part Level (*)
	<b>910006749</b>	<b>e-Jet equipped with one 6 m Mach-Jet Gun and one 12 m Mach-Jet Gun</b>	<b>1</b>	<b>1</b>	<b>3</b>
1	130000002	Tee Union	1	1	3
2	U1CBBW003	Red polyamide hose 6/8	0.2	m	2
3	130000005	Yellow polyurethane hose 4/6	2.8	m	2
4	130000001	Quick-release Y-shaped union	1	1	3
5	U1CBBT005	Blue polyamide hose 8/10	10	m	2
6	E4PCAL459	US Mains power cable	2	1	3
7	842635	5-m ground cable, lug dia.: 6	2	1	3
8	F6RLRR314	Quick-release diameter adapter	2	1	3
9	U1CBBW005	Red polyamide hose 8/10	10	m	2
10	F6RRAF043	Double check union	2	1	3
11	F6RLTS416	Tee Union	1	1	3
12	130000624	Black semi-conducting polyurethane hose - 5.5/8	11.4	m	2
13	130000625	Black semi-conducting polyurethane hose - 4/6	11.4	m	2
<b>14</b>	<b>1523297</b>	<b>CRN 457 control module</b> ( <a href="#">see RT Nr 6336</a> )	<b>2</b>	<b>1</b>	<b>3</b>
<b>15</b>	-	<b>e-Jet cart</b> ( <a href="#">see § 9.5 page 31</a> )	<b>1</b>	<b>not sold separately</b>	<b>-</b>
16	E3GPLN018	PVC sheath, black	0,8	m	2
17	U1FGBA092	Hose EAV 11X15	12	m	1
<b>18</b>	<b>1526401</b>	<b>CS 237 plunger</b> ( <a href="#">see RT Nr 6368</a> )	<b>2</b>	<b>1</b>	<b>1</b>
19	900003577	Fast Pump	2	1	3
<b>Not shown</b>					
	<b>1524463</b>	<b>Mach-Jet Gun (6 m)</b> ( <a href="#">see RT Nr 6336</a> )	<b>1</b>	<b>1</b>	<b>3</b>
	<b>1524463-12</b>	<b>Mach-Jet Gun (12 m)</b> ( <a href="#">see RT Nr 6336</a> )	<b>1</b>	<b>1</b>	<b>3</b>
	<b>910007107</b>	<b>Air supply kit</b> ( <a href="#">see § 9.7 page 34</a> )	<b>1</b>	<b>1</b>	<b>3</b>
<b>For 2nd CRN 457</b>					
	F6RLDS408	Quick-release bracket, dia.: 8	2	1	3
	F6RLDS207	Quick-release bracket, dia.: 6	1	1	3
	F6RLDS145	Quick-release bracket, dia.: 10	1	1	3
	822542	Support bracket assembly for 2nd CRN 457	1	1	3

**Level 1: Standard preventive maintenance**

**Level 2: Corrective maintenance**

**Level 3: Exceptional maintenance**

### 9.5. E-Jet cart

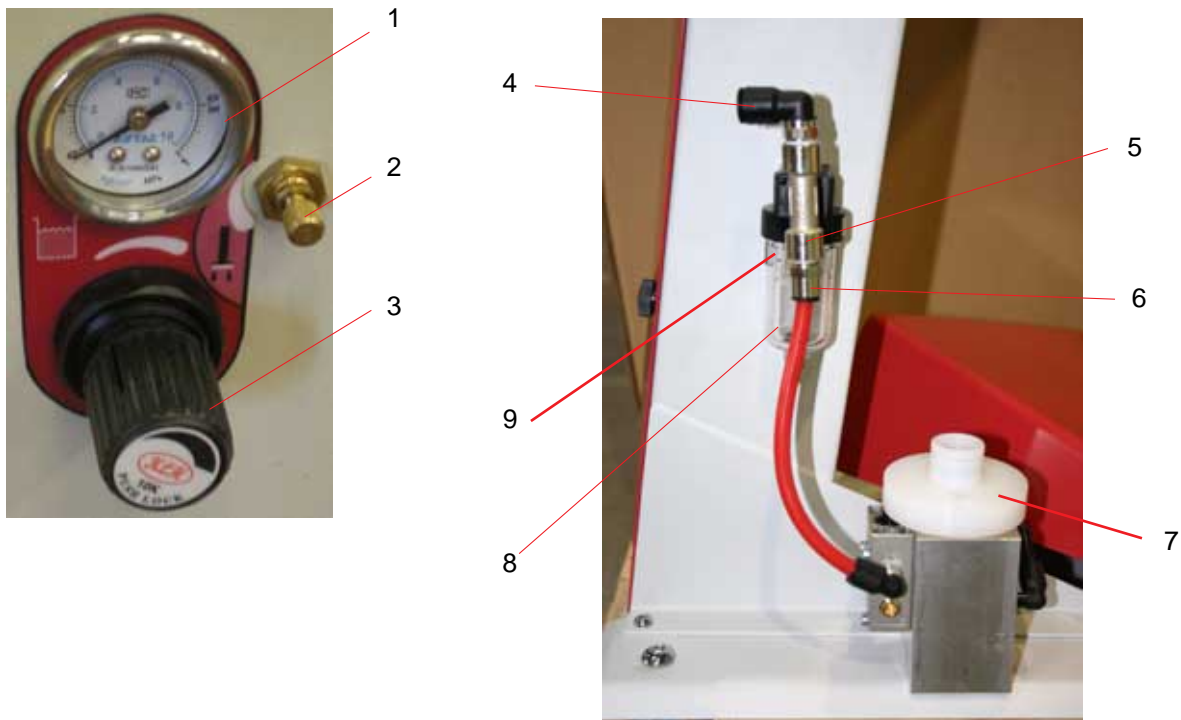

Item	Part number	Description	Qty	Unit of sale	Spare Part Level (*)
	-	<b>e-Jet Cart</b>	<b>1</b>	<b>not sold separately</b>	<b>-</b>
1	R7MCAD061	Pressure gauge	1	1	3
2	220000145	Adjustable flow-rate restrictor	1	1	3
3	R4DREG029	Regulator	1	1	3
4	F6RLCS204	Male union	1	1	3
5	130000674	2 x 1/4 BSP female- 1/4 BSP male nickel-plated branch tee	1	1	3
6	F6RLUS204	Male union	1	1	3
<b>7</b>	<b>1527409</b>	<b>Fast Clean (see RT Nr 6410)</b>	<b>1</b>	<b>1</b>	<b>3</b>
8	R4DACC200	Manual flush filter	1	1	1
9	R4DFCM199	Filter cartridge	1	1	3
<b>Not shown</b>					
-	130000747	Pivoting roller	4	1	3
-	130000746	Hook of gun fixing	1	1	3

(\*)

**Level 1: Standard preventive maintenance**

**Level 2: Corrective maintenance**

**Level 3: Exceptional maintenance**

### 9.5.1. Vibrating table assembly

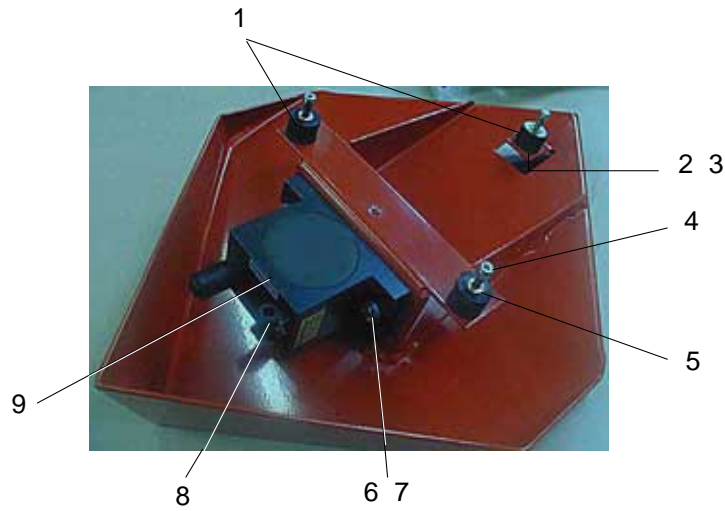

Item	Part number	Description	Qty	Unit of sale	Spare Part Level (*)
	-	<b>Vibrating table assembly</b>	<b>1</b>	<b>Not sold separately</b>	<b>-</b>
1	Q4BPGS105	Damper	3	1	2
2	X2BVHA222	Screw H M 6 x 12 white zinc coated steel 8/8 (screw fixing damper to table)	3	1	2
3	X3CDSP783	Self-locking washer	3	1	3
4	X2BEHS006	Nylstop nut M6	3	1	2
5	X2BDMU006	Washer M 6 U zinc coated steel	3	1	2
6	X2BVHA286	Screw H M 8 x 35 white zinc coated steel 8/8	2	1	3
7	X2BDMU008	Washer M 8 U zinc coated steel	2	1	3
8	F6RLCS411	Cylindrical male union bracket 8 1/4	1	1	2
9	180000061	Pneumatic vibrator	1	1	2

(\*)

**Level 1: Standard preventive maintenance**

**Level 2: Corrective maintenance**

**Level 3: Exceptional maintenance**



**9.6. e-Jet hose kit**



Item	Part number	Description	Qty	Unit of sale	Spare Part Level (*)
	<b>910006386</b>	<b>e-Jet hose kit</b>	<b>1</b>	<b>1</b>	<b>2</b>
1	130000624	Black semi-conducting polyurethane hose - 5.5/8 (injection)	1.4	m	2
2	130000005	Yellow polyurethane hose 4/6	1.4	m	2
3	130000625	Black semi-conducting polyurethane hose - 4/6 (dilution)	1.4	m	2
4	E3GPLN018	PVC sheath, black	0.8	m	2

(\*)

**Level 1: Standard preventive maintenance**

**Level 2: Corrective maintenance**

**Level 3: Exceptional maintenance**

### 9.7. Air supply kit intended for the Canadian and American market

This kit is optional for Europe market



Item	Part number	Description	Qty	Unit of sale	Spare Part Level (*)
	<b>910007107</b>	<b>Air supply kit</b>	<b>1</b>	<b>1</b>	<b>3</b>
1	220000120	1/4 male/female union	1	1	3
2	F6RLHG362	NPT 1/4 Conical adapter	1	1	3

(\*)

**Level 1: Standard preventive maintenance**

**Level 2: Corrective maintenance**

**Level 3: Exceptional maintenance**